

TOP VIEW

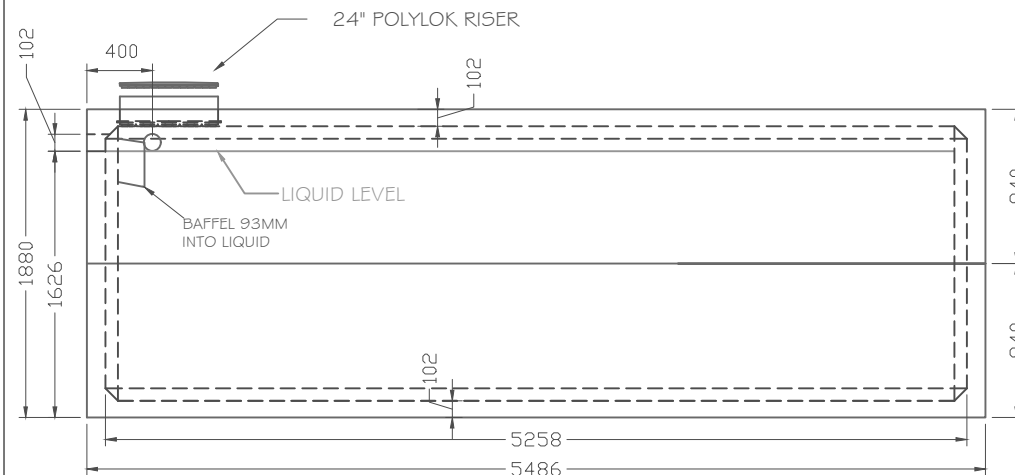

SIDE VIEW

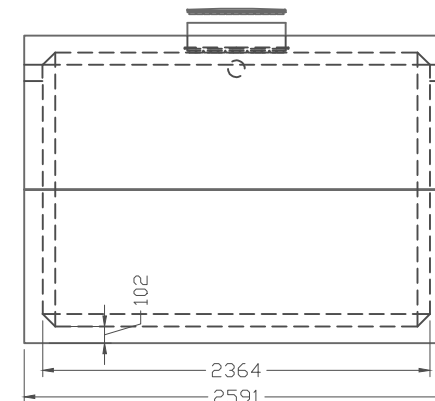

END VIEW

GENERAL:

ALL DIMENSIONS IN MILLIMETERS
+/- 10mm TOLERANCES ON ALL DIMENSIONS

CONCRETE:

STANDARD
STANDARD ACC (ACCELERATED STRIPPING)
10 MPa @ STRIPPING STRENGTH
35 MPa @ 28 DAYS
C-1 EXPOSURE CLASS
SULPHATE RESISTANT
4.4 CUBIC YARDS (TANK)
4.4 CUBIC YARDS (LID)

REINFORCING:

ALL REINF. HAS MIN. 25mm OF COVER

TANK:

10M @ 300mm O/C EW

LID:

10M @ 300mm O/C EW
CORNER BARS AROUND RISERS

WEIGHT:

TOP SECTION APPROX. - 14,336 LBS/6516 KG
BTM SECTION APPROX. - 14,510 LBS/6595 KG
ASSEMBLED APPROX. - 28,846 LBS/13,111 KG

NOTES:

JOINT SEALANT IS MASTIC SEALANT (CONCEAL CS-102)
(NSF APPROVED SEALANT AVAILABLE FOR PORTABLE
WATER HOLDING TANKS)
TANK ASSEMBLED IN FACTORY
1.5M MAXIMUM BURIAL
INLETS ARE 4" POLYLOK PIPE SEALS
LID AND RISER ARE 24" DIAMETER POLYLOK



PRODUCT:

4220 GAL/ 19,160 L HOLDING TANK

PRODUCT ID:

HTC 4220

CONTRACTOR:

SCALE:

N.T.S

REV	DATE	INI.	DESCRIPTION
0	03/23/ 20	LP	ORIGINAL DRAWING